

Non Insulated Copper Tubular Metric Lugs

HYLUG™

Two Hole Metric Conductor Lug with Inspection Window

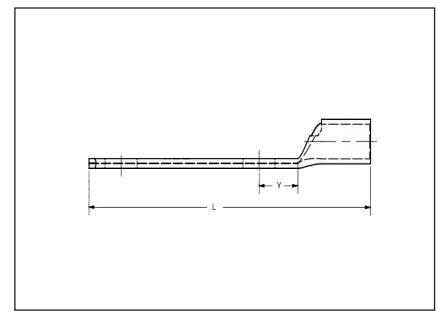

Made from electrolytic copper tube and electro tin plated. Wire range is from 1.5mm² to 630mm² for class 2 and class 5. Compatible to **IEC61238-1**.

Catalog Number	*Wire Size (MM ²)	Stud Size	Dimensions (MM ²)				Die Index	Installation Tooling (# Crimps)			Wire Strip Length (mm)
			Tongue Width	Stud Hole Spacing	L Max.	Y Min.		Mechanical	Hydraulic	Dieless	
								MD6, OUR840, MD7-34R	Y35, Y39, Y750, PAT750, **Y46, PAT46**		
YAV352M10	35	M 10	17.2	44.5	90.7	16.3	10	W2CVT (1) W2CRT (1) X2CRT (1)	U2CRT (1)	MY29-3 (1) MY29-11 (1) Y1MRTC (2) Y4PC834/PAT4PC834 (1) Y644HSXT/PAT644HSXT (1) Y81KFT/PAT81KFT-18V (1)	17
YAV502M10	50	M 10	17.2		90.7	12.5	12	W25RT (2) X25RT (2) W25VT (2)	U25RT (1)	MY29-3 (1) MY29-11 (1) Y4PC834/PAT4PC834 (1) Y644HSXT/PAT644HSXT (1) Y81KFT/ PAT81KFT-18V (1)	
YAV702M10	70	M 10	21.0		93.9		13	W26RT (2) X26RT (2) W26VT (2)	U26RT (1)		
YAV952M12	95	M 12	23.7		104.6	14.1	14	X27RT (3) W27RT (2) W27VT (2)	U27RT (1)	MY29-11 (3) Y4PC834/PAT4PC834 (1) Y81KFT/ PAT81KFT-18V (1) Y644HSXT/PAT644HSXT (1)	22
YAV1202M12	120	M 12	29.0		112.4		15	W28VT (2) W28RT (2) X28RT (2)	U28RT (1)	Y4PC834/PAT4PC834 (2) Y644HSXT/PAT644HSXT (1) Y81KFT/ PAT81KFT-18V (2)	27
YAV1502M12	150	M 12	30.5		112.9	15.7	17	W30VT (2)	U30RT (2)		
YAV1852M12	185	M 12	32.8		114.5		18	W31VT (2)	U31RT (2)		
YAV2402M12	240	M 12	39.4		123.9	16.4	20	W34VT (2)	U34RT (2)	Y4PC834/PAT4PC834 (3) Y644HSXT/PAT644HSXT (1) Y81KFT/ PAT81KFT-18V (3) Y81KFTMBH (3)	33
YAV3002M12	300	M 12	44.2		128.1	13.9	22	-	U36RT (2)		35
YAV4002M12	400	M 12	50.2		131.7		24	-	U39RT (2) P39RT (2)	37	
YAV5002M12	500	M 12	55.7		140.9		L115	-	U44XRT (2)	43	
YAV6302M12	630	M 12	62.5		152.4	29	-	P45RT (3)	-	55	

+ P-RT Die set for use with Y46 HYPRESS™

** Use PUADP-1 Adaptor with U-Dies in Y46 HYPRESS™

NOTE: All dimensions shown are for reference only

NOTE:

* Sizes 1.5 to 35 mm² are for class 2 and 5. All other sizes are for Class 2 only, except where noted.